

proposed floor plans showing levels 4 and 4.5 - scale 1 : 100
 (total 63 bays)

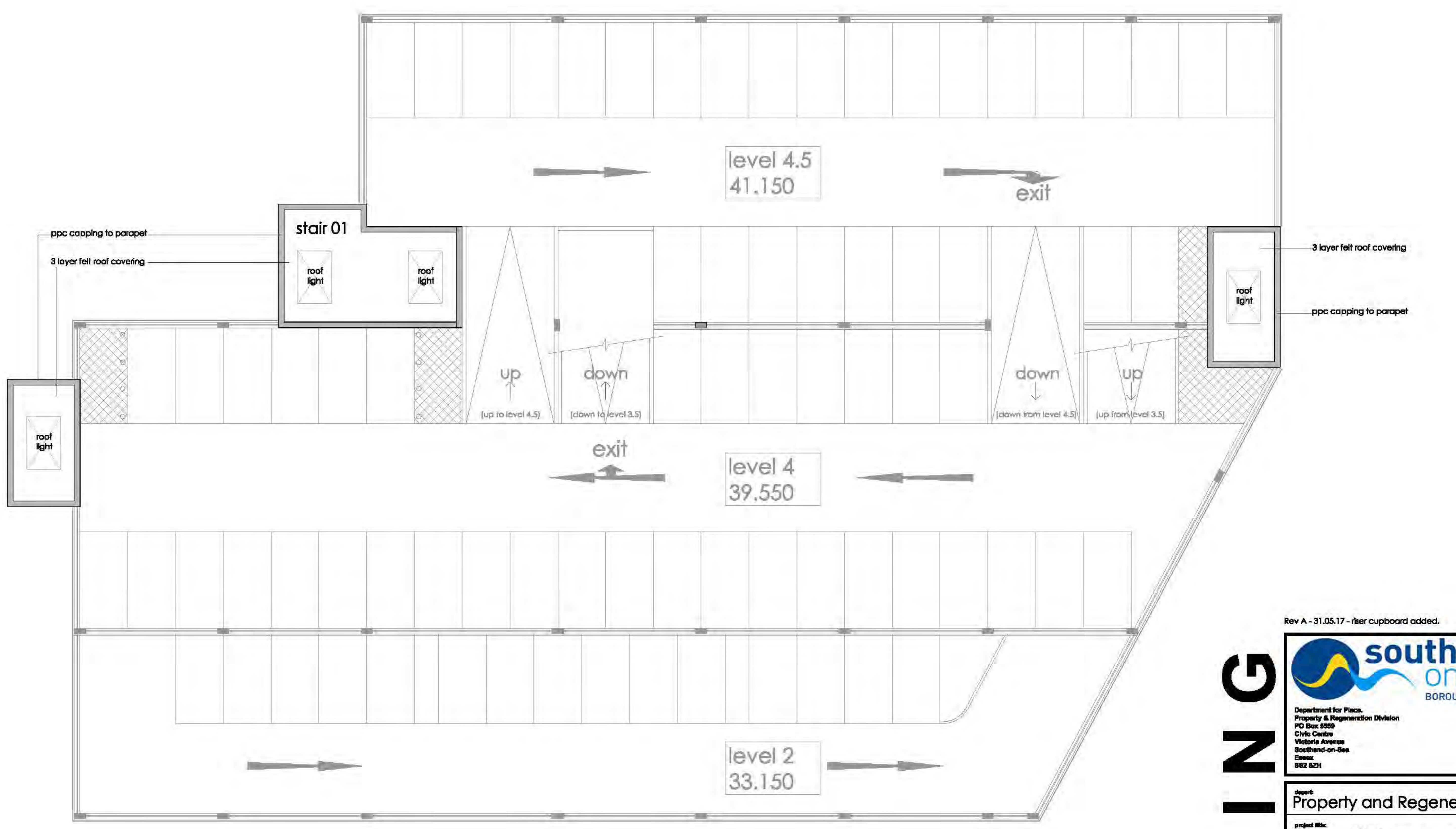

proposed roof plan - scale 1 : 100

Rev A - 31.05.17 - riser cupboard added.

southend on sea
 BOROUGH COUNCIL
 Department for Place,
 Property & Regeneration Division
 PO Box 9909
 Civic Centre
 Victoria Avenue
 Southend-on-Sea
 Essex
 S12 6ZH

Department for Place,
 Property and Regeneration
 project title:
new multi storey car park

site:
 new multi storey car park
 Victoria Avenue
 Southend-on-Sea
 drawing title:
**proposed floor plans
 levels 4, 4.5 and roof plan**

scale:
 1 : 100
 date:
 February 2017
 drawing no:
1440/P/103
 sheet no:
 sheet 4 of 7
 revision:
A

PLANNING